



SPECIFICATION

Slice US



Product Details

S/N Rules

$\frac{SL}{1} - \frac{X}{2} \frac{XX}{3} \frac{XX}{4} - \frac{X}{5} - \frac{X}{6}$

EX: $\frac{SL-P2250-P}{1} \frac{B}{2} \frac{3}{3} \frac{4}{4} \frac{5}{5} \frac{6}{6}$

1. SL- ShineLong
2. X- Shape: "P" = square panel;
3. XX-Size: 11 = 1x1ft; 22 = 2x2ft,24=2x4ft...
4. XX- Watt: 20=20w; 30=30w;40=40w(according to actual watt)
5. X- CCT: P=pure white; W=warm white; C=cool white;
6. X- Optional function: P=PWM dimmable;
D=0/1-10V dimmable; T=triac dimmable; L=DALI dimmable;
B=battery(emergency)

Application

- Office
- University/School
- Show room
- Library
- Hospital
- Exhibition Hall
- Supermarket

Features

- Ultra-thin 10mm
- Instant on/off, no noise/UV/light leak/shadow
- UL, CUL, DLC Premium certified
- Material: AL + PMMA
- IK06, IP40
- Global patent protection led source, projected lifespan>100,000hrs
- UL 0~10V dimmable driver
- 100lm/w, 130lm/w optional
- L80B50 Lifespan(Ta=25°C): 70,000hrs
- SDCM<4
- 5 years warranty

Temperature

Operating: -20 ~ +50°C



Product Details



Data Sheet

Article Number	Size	Power	LEDs	Beam Angle	CRI	AC Input	DC Output	SDCM	Efficiency (±5%)	Lumen Output
----------------	------	-------	------	------------	-----	----------	-----------	------	------------------	--------------

DLC 4.2 Standard Lumen Version

SL-P1440-X	302*1211mm	40W	260	120°	>80	100~277V	30~40V	<4	100lm/w	3800~4200lm
SL-P2240-X	602*602mm	40W	208	120°	>80	100~277V	30~40V	<4	100lm/w	3800~4200lm
SL- P2460-X	602*1211mm	60W	312	120°	>80	100~277V	30~40V	<4	100lm/w	5700~6300lm

DLC 4.2 Premium Lumen Version

SL-P2230-X	602*602mm	30W	260	120°	>80	100~277V	30~40V	<4	130lm/w	3750~4050lm
SL- P2450-X	602*1211mm	50W	312	120°	>80	100~277V	30~40V	<4	130lm/w	6250~6750lm

Different wattage can be customized

Flexibility

① Standard version

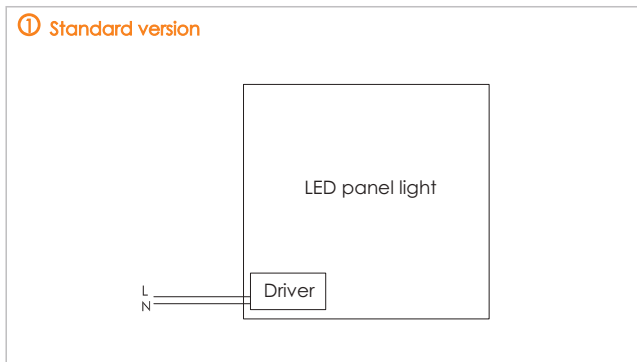

② 0/1-10V dimming version

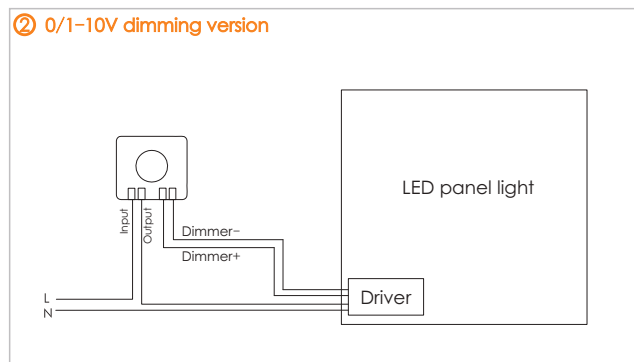

③ Triac-dimming version

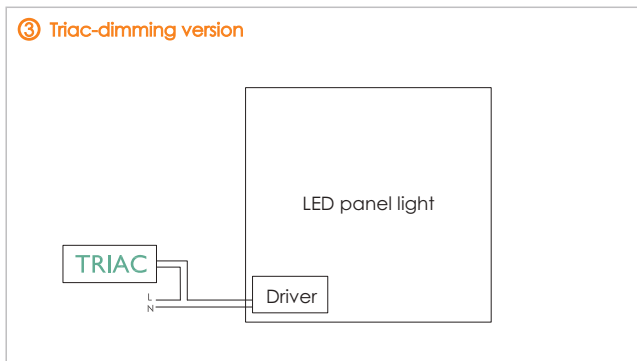

④ Emergency version

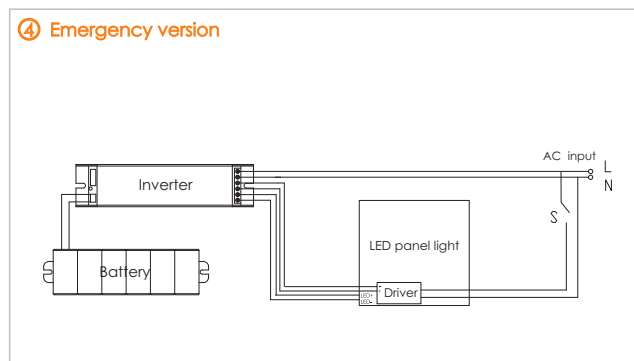

Recessed Installation

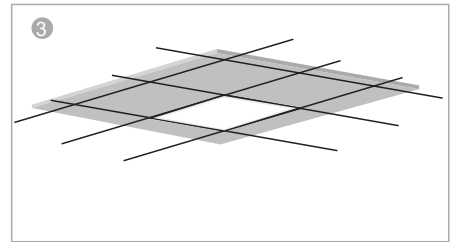
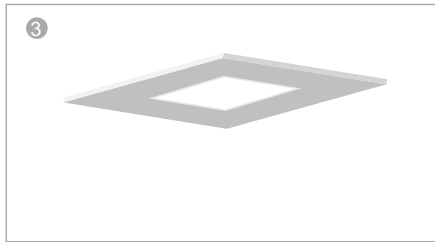
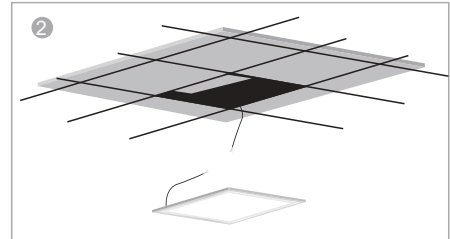
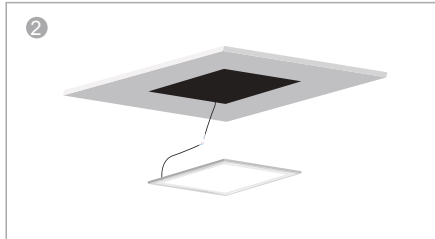
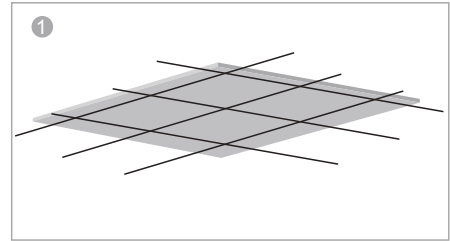
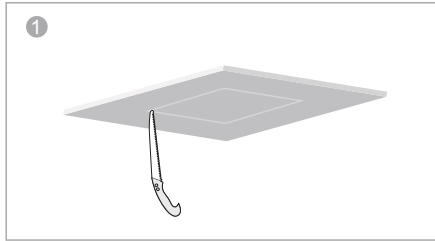

Suspended Installation

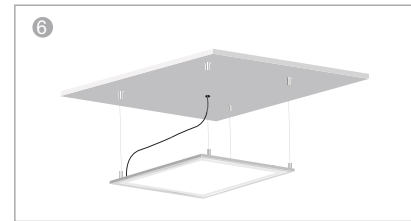
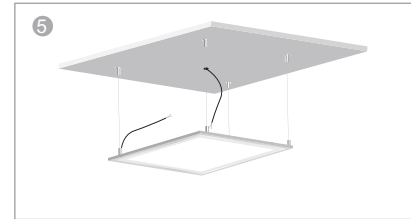
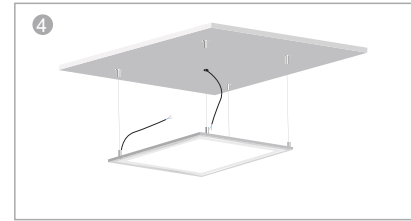
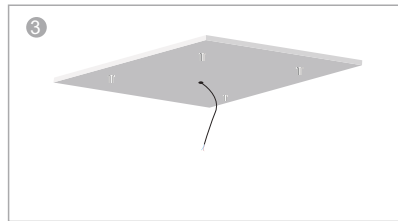
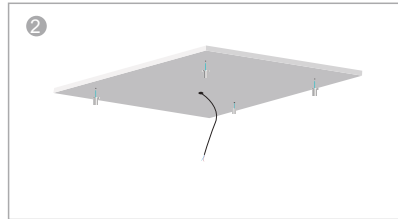
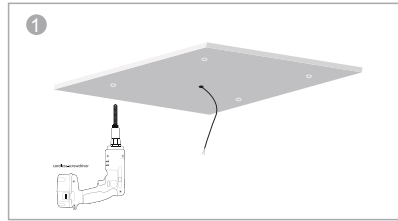

PLS NOTE: Recessed installation is ShineLong standard configuration.
Suspended or surface mounted installation will be charged additionally by hanging ropes or mounted frame.

Ceiling mounted Installation

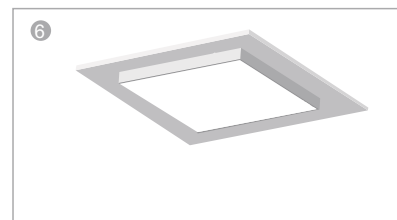
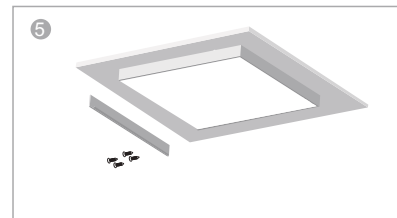
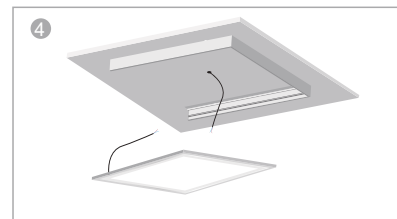
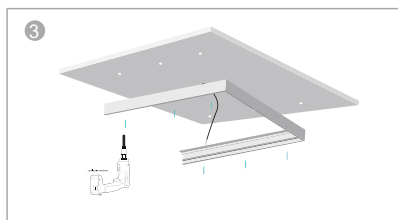
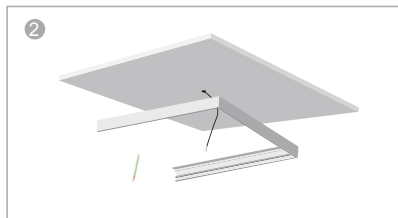
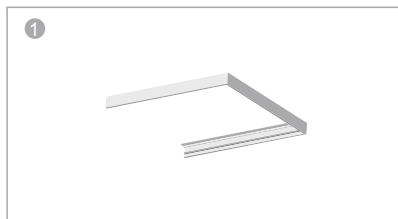
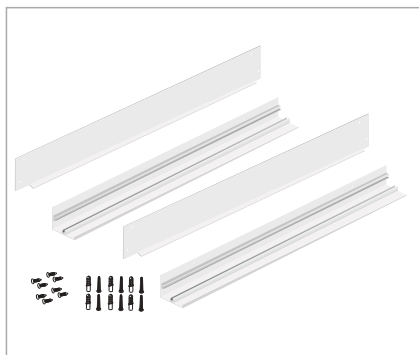

PLS NOTE: Recessed installation is ShineLong standard configuration.
Suspended or surface mounted installation will be charged additionally by hanging ropes or mounted frame.

Package

Item code	Size	Carton Size	N.W./CTN	G.W./CTN	Maximum Loading of		
					20'GP	40'GP	40'HQ
SL-P1440-X	302*1211*10mm	130X300X440mm	14kg	18kg	249CTNs	510CTNs	561CTNs
SL-P2230-X / SL-P2240-X	602*602*10mm	680X300X700mm	14kg	18kg	228CTNs	472CTNs	540CTNs
SL- P2450-X / SL- P2460-X	602*1211*10mm	1300X300X740mm	28kg	35kg	132CTNs	274CTNs	312CTNs

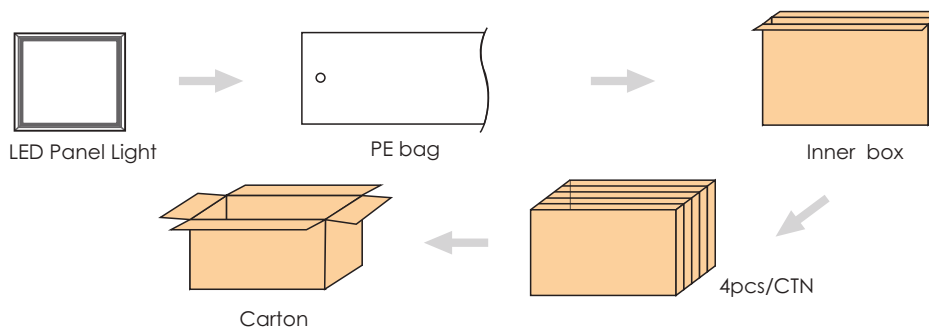

All the above information is subject to the final interpretation of ShineLong Technology.