

SPECIFICATION

Slice EU



Product Details

S/N Rules

$\frac{SL}{1} - \frac{X}{2} \frac{X}{3} \frac{X}{4} - \frac{X}{5} \frac{X}{6}$

EX: $\frac{SL}{1} - \frac{P2250}{234} - \frac{P}{5} \frac{B}{6}$

1. SL- ShineLong
2. X- Shape: "P" = square panel;
3. XX-Size: 11 = 1x1ft; 22 = 2x2ft,24=24xft...
4. XX- Watt: 20=20w; 30=30w;40=40w(according to actual watt)
5. X- CCT: P=pure white; W=warm white; C=cool white;
6. X- Optional function: P=PWM dimmable;
D=0/1-10V dimmable; T=triac dimmable; L=DALI dimmable;
B=battery(emergency)

Application

- Office
- University/School
- Show room
- Library
- Hospital
- Exhibition Hall
- Supermarket

Features

- Ultra-thin 10mm
- Instant on/off, no noise/UV/light leak/shadow
- CE, RoHS, ERP, SAA, TUV certified
- Material: AL + PMMA
- IK06, IP40
- Global patent protection led source, projected lifespan>100,000hrs
- TUV/ENEC listed driver, flicker free
- 100lm/w, 130lm/w optional
- Available in non-dimming, 0~10V / Triac / DALI / CCT dimming, emergency versions
- L80B50 Lifespan(Ta=25°C): 70,000hrs
- SDCM<4
- 5 years warranty

Temperature

Operating: -20 ~ +50°C



Product Details



Data Sheet

| Article Number | Size | Power | LEDs | Beam Angle | CRI | AC Input | DC Output | SDCM | Efficiency (±5%) | Lumen Output |
|-------------------------------|------------|-------|------|------------|-----|----------|-----------|------|------------------|--------------|
| Standard Lumen Version | | | | | | | | | | |
| SL-P1112-X | 295*295mm | 12W | 78 | 120° | >80 | 200~240V | 30~40V | <4 | 90lm/w | 1000~1100lm |
| SL-P1125-X | 295*295mm | 25W | 78 | 120° | >80 | 200~240V | 30~40V | <4 | 90lm/w | 2100~2400lm |
| SL-P1440-X | 295*1195mm | 40W | 260 | 120° | >80 | 200~240V | 30~40V | <4 | 100lm/w | 3800~4200lm |
| SL-P2240-X | 595*595mm | 40W | 156 | 120° | >80 | 200~240V | 30~40V | <4 | 100lm/w | 3800~4200lm |
| SL-P2250-X | 595*595mm | 50W | 208 | 120° | >80 | 200~240V | 30~40V | <4 | 100lm/w | 4750~5250lm |
| SL-P2240-X | 620*620mm | 40W | 156 | 120° | >80 | 200~240V | 30~40V | <4 | 100lm/w | 3800~4200lm |
| SL-P2250-X | 620*620mm | 50W | 208 | 120° | >80 | 200~240V | 30~40V | <4 | 100lm/w | 4750~5250lm |
| SL-P2460-X | 595*1195mm | 60W | 312 | 120° | >80 | 200~240V | 30~40V | <4 | 100lm/w | 5700~6300lm |
| Premium Lumen Version | | | | | | | | | | |
| SL-P1440-X | 295*1195mm | 40W | 364 | 120° | >80 | 200~240V | 30~40V | <4 | 130lm/w | 5000~5400lm |
| SL-P2240-X | 595*595mm | 40W | 208 | 120° | >80 | 200~240V | 30~40V | <4 | 130lm/w | 5000~5400lm |
| SL-P2250-X | 595*595mm | 50W | 260 | 120° | >80 | 200~240V | 30~40V | <4 | 130lm/w | 6250~6750lm |
| SL-P2240-X | 620*620mm | 40W | 208 | 120° | >80 | 200~240V | 30~40V | <4 | 130lm/w | 5000~5400lm |
| SL-P2250-X | 620*620mm | 50W | 260 | 120° | >80 | 200~240V | 30~40V | <4 | 130lm/w | 6250~6750lm |
| SL-P2460-X | 595*1195mm | 60W | 364 | 120° | >80 | 200~240V | 30~40V | <4 | 130lm/w | 7500~8100lm |

Different wattage can be customized

Flexibility



Male and female connectors

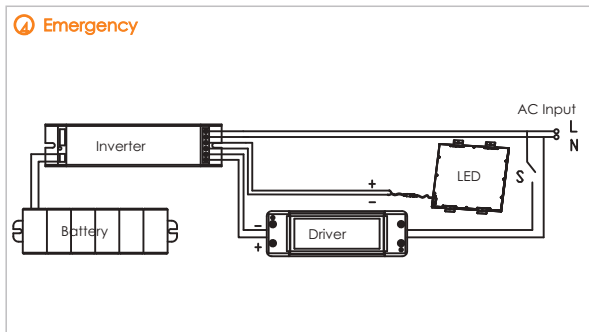
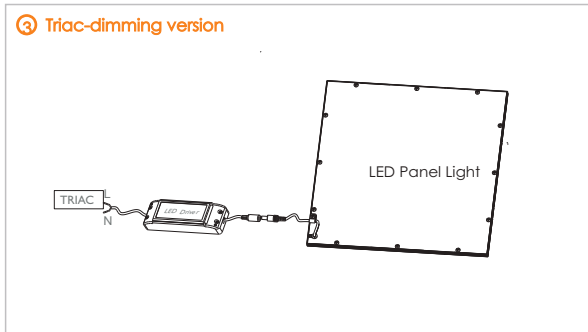
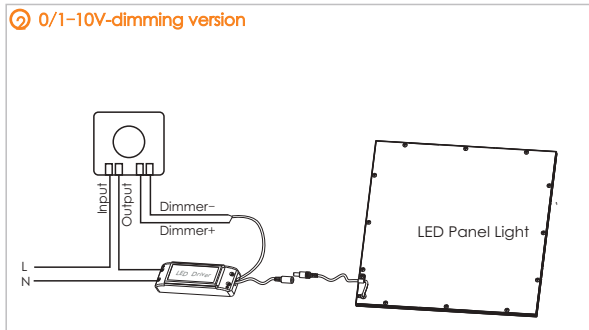
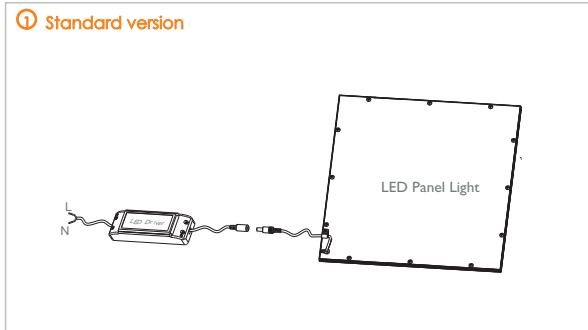

Recessed Installation

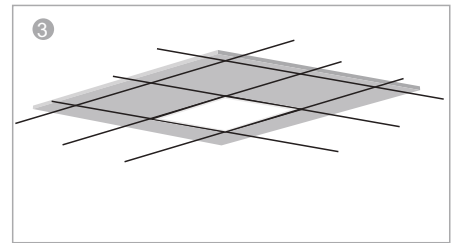
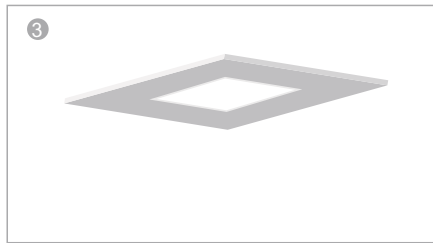
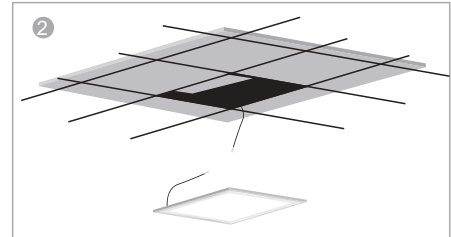
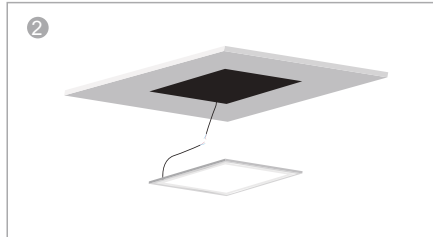
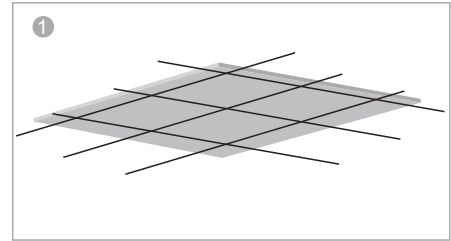
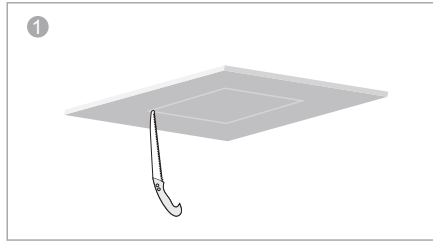

Suspended Installation

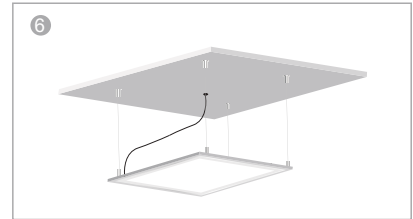
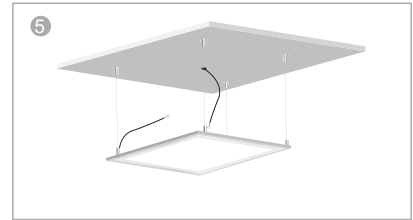
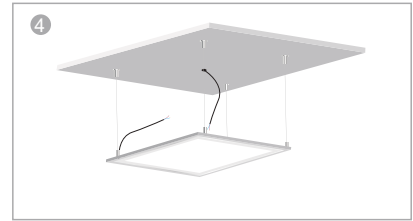
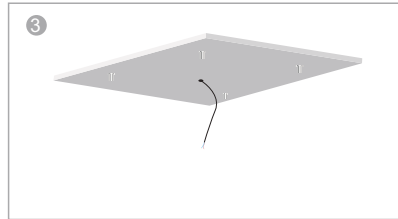
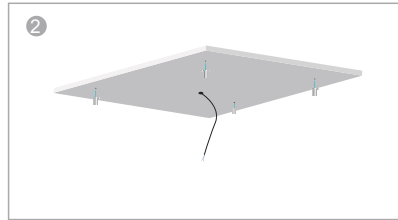
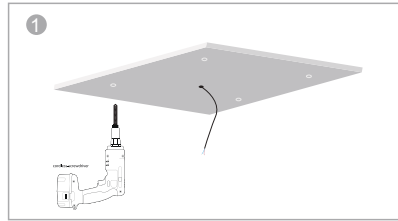

PLS NOTE: Recessed installation is ShineLong standard configuration.
Suspended or surface mounted installation will be charged additionally by hanging ropes or mounted frame.

Ceiling mounted Installation

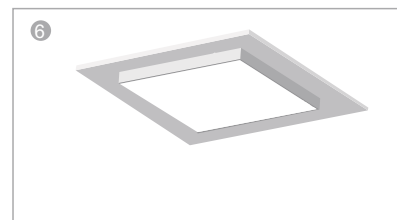
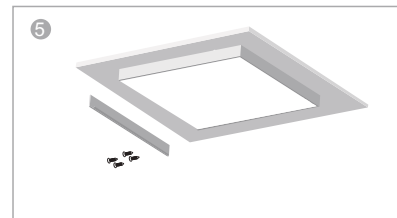
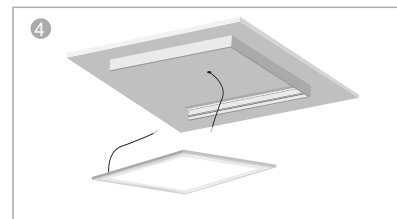
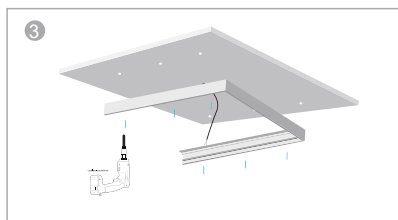
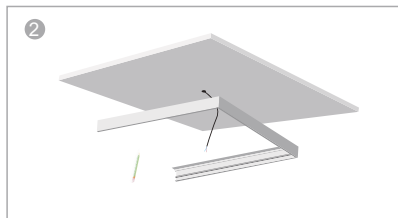
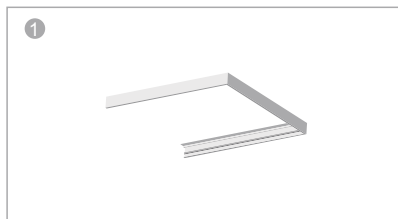
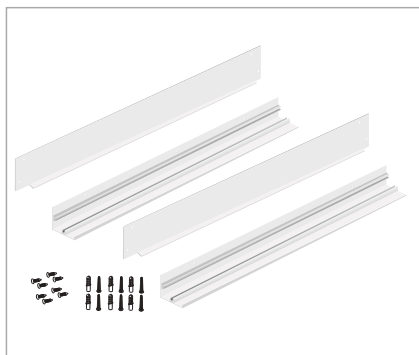

PLS NOTE: Recessed installation is ShineLong standard configuration.
Suspended or surface mounted installation will be charged additionally by hanging ropes or mounted frame.

Package

| Item code | Size | Carton Size | N.W./CTN | G.W./CTN | Maximum Loading of | | |
|-------------------------------------|---------------|----------------|----------|----------|--------------------|---------|---------|
| SL-P1112-X / SL-P1125-X | 295*295*10mm | 440X260X400mm | 7kg | 9kg | 20'GP | 40'GP | 40'HQ |
| SL-P2240-X / SL-P2250-X/ SL-P2260-X | 595*595*10mm | 740X260X690mm | 16kg | 20kg | 249CTNs | 510CTNs | 561CTNs |
| SL-P2240-X / SL-P2250-X/ SL-P2260-X | 620*620*10mm | 760X260X710mm | 17kg | 21kg | 228CTNs | 472CTNs | 540CTNs |
| SL-P1440-X | 295*1195*10mm | 1300X260X440mm | 16kg | 20kg | 132CTNs | 274CTNs | 312CTNs |
| SL- P2460-X | 595*1195*10mm | 1300X260X740mm | 35kg | 40kg | 121CTNs | 247CTNs | 288CTNs |

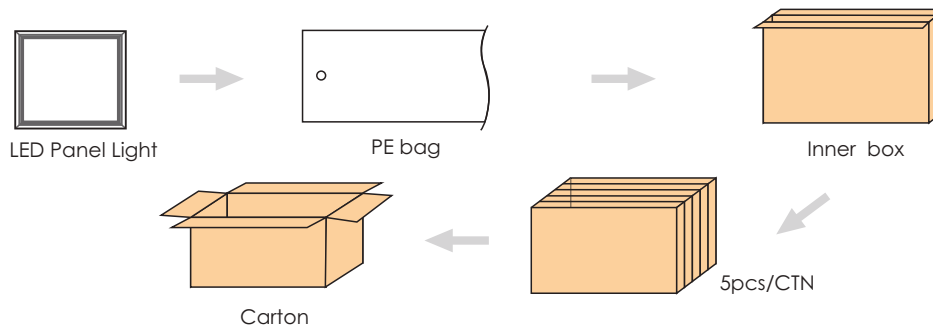

All the above information is subject to the final interpretation of ShineLong Technology.